

PART NUMBER

KAD177160

REV.

DATE

COMMENTS

INITIAL

Electrical Data

Impedance 50 Ω
 Frequency Range DC - 26.5 GHz.
 VSWR 1.10 Max @ DC-6 GHz
 1.15 Max @ 6-12.4 GHz
 1.20 Max @ 12.4-18 GHz
 1.30 Max @ 18-26.5 GHz

Mechanical Data

Temperature Range: -55 °C - 125 °C

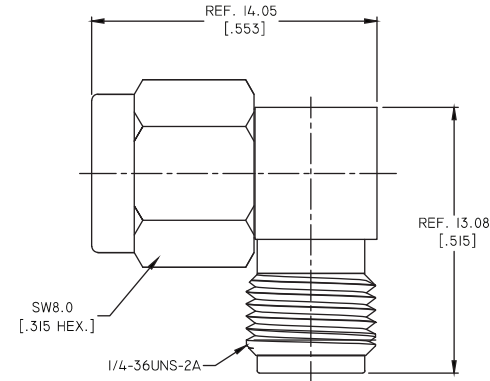
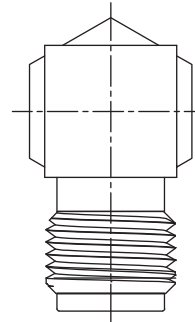
RoHS Compliant

Drawing not to scale. Dimensions for reference only

Units: mm (inches)

Konnect RF

WWW.KONNECTRF.COM
 1-800-790-5887

PART NUMBER

KAD177160

DESCRIPTION

Precision Adapter, In-Series, SMA Right Angle Male Plug to Female Jack

CAGE CODE

664U0

SIGNATURE

X

THIS DRAWING INCLUDING THE DESIGNS IS THE PROPERTY OF KONNECT RF AND IS NOT TO BE USED FOR ANY PURPOSE WITHOUT OUR APPROVAL.

Component

Body & Coupling Nut
 Center Contact
 Gasket
 Insulator

Material

Stainless Steel
 BeCu
 Silicone Rubber
 PTFE

Plating/Finish

Passivated
 Gold