

PART NUMBER

**KAD177087**

REV.

DATE

COMMENTS

INITIAL

**Electrical Data**

Impedance 50  $\Omega$   
 Frequency Range DC - 4 GHz.  
 Working Voltage 500 VRMS @ Sea Level  
 Insulation Resistance 5,000 M $\Omega$

**RoHS Compliant****Mechanical Data**

Temperature Range: -65 °C - 165 °C

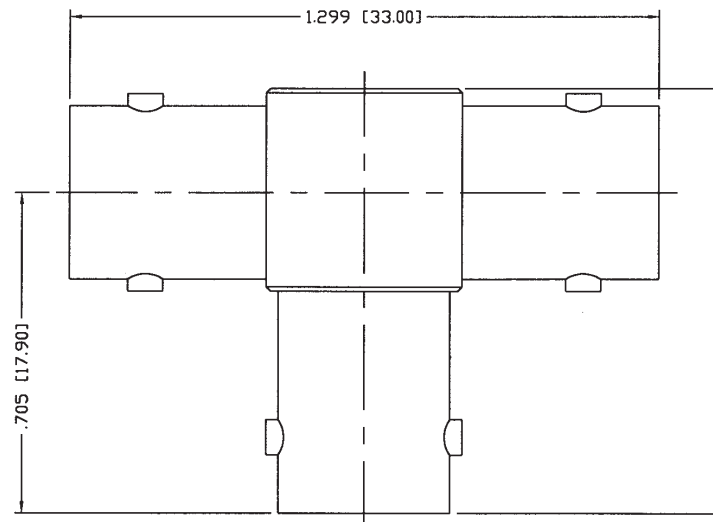

Drawing not to scale. Dimensions for reference only

Units: inches (mm)

**Konnnect RF**

WWW.KONNECTRF.COM  
 1-800-790-5887

PART NUMBER

**KAD177087**

DESCRIPTION

**Adapter, T-Type, BNC Female Jack to Female Jack to Female Jack**

CAGE CODE

**664U0**

SIGNATURE

**X**

THIS DRAWING INCLUDING THE  
 DESIGNS IS THE PROPERTY OF  
 KONNECT RF AND IS NOT TO  
 BE USED FOR ANY PURPOSE  
 WITHOUT OUR APPROVAL.

**Component**

Body & Press Body  
 Center Contact  
 Lock Ring  
 Sleeve  
 Insulator

**Material**

Brass  
 Phos. Bronze  
 Brass  
 Delrin  
 PTFE

**Plating**

Nickel  
 Silver  
 Nickel