

PART NUMBER

**KAD177010**

REV.

DATE

COMMENTS

INITIAL

**Electrical Data**

|                                 |                              |
|---------------------------------|------------------------------|
| Impedance                       | 50 $\Omega$                  |
| Frequency Range                 | DC - 12.4 GHz.               |
| Insertion Loss                  | 0.05 $\sqrt{F}$ (GHz) dB Max |
| Voltage Rating                  | 500 VRMS                     |
| Contact Retention               | 6lbs axial                   |
| Dielectric Withstanding Voltage | 1,500 VRMS                   |
| VSWR                            | 1.10 +0.1x $F$ (GHz) Max     |

**Mechanical Data**

|                    |                 |
|--------------------|-----------------|
| Durability         | 500 Cycles Min. |
| Temperature Range: | -50 °C - 125 °C |

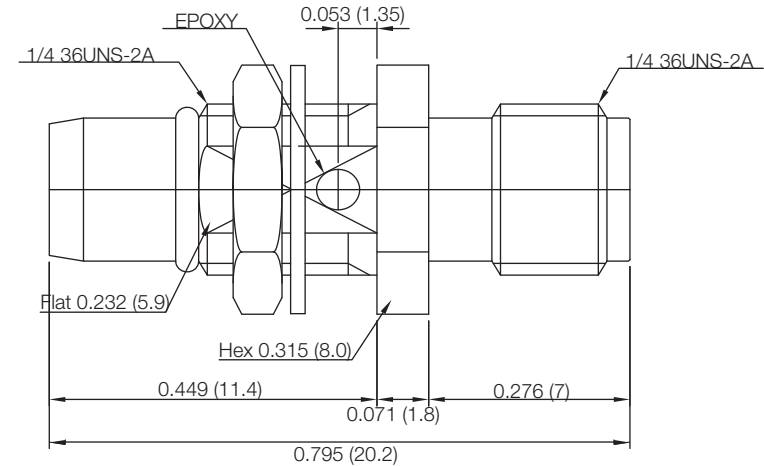
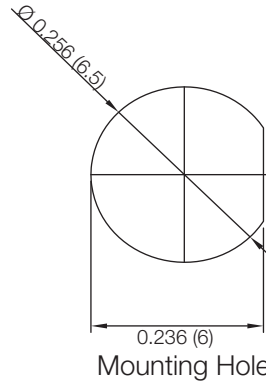
**RoHS Compliant**

Drawing not to scale. Dimensions for reference only

Units: inches (mm)

**Konnect RF**

WWW.KONNECTRF.COM  
1-800-790-5887

PART NUMBER

**KAD177010**

DESCRIPTION

**Adapter, Between Series, SMA Female  
Jack to BMA Male Jack Bulkhead Mount, Epoxy Captivated**

CAGE CODE

**664U0**

SIGNATURE

X

THIS DRAWING INCLUDING THE  
DESIGNS IS THE PROPERTY OF  
KONNECT RF AND IS NOT TO  
BE USED FOR ANY PURPOSE  
WITHOUT OUR APPROVAL.

**Component**

Body, Nut & Washer  
Center Contact  
Insulator  
O-Ring

**Material**

Brass  
BeCu  
PTFE  
Silicone Rubber

**Plating**

White Bronze  
Gold