

PART NUMBER

**KSW177520**

REV.

INITIAL

**Electrical Data**

Impedance	50 $\Omega$
VSWR	1.5:1 Max.
Insertion Loss	2 dB Max.
	4 dB Max.
Isolation	75 dB Min.
	65 dB Min.
	55 dB Min.
Switching Speed	10 Microseconds
RF Input Power	+20 dBm average
	+30 dBm average
Operating Temperature	0°C to +70°C
Storage Temperature	-55°C to +90°C

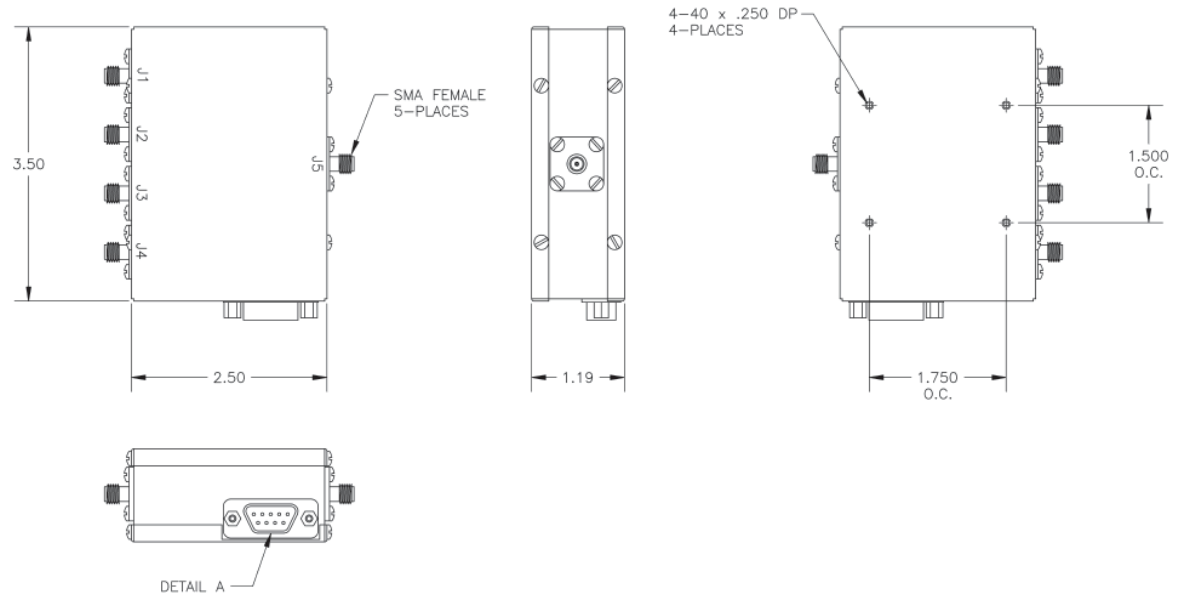
**RoHS Compliant**

Drawing not to scale. Dimensions for reference only

Units: mm

**Konnect RF**

WWW.KONNECTRF.COM  
1-800-790-5887

PART NUMBER

**KSW177520**

DESCRIPTION

**Switch, 1P4T, Self Terminating Solid State, SMA**

CAGE CODE

**664U0**

SIGNATURE

X

THIS DRAWING INCLUDING THE  
DESIGNS IS THE PROPERTY OF  
KONNECT RF AND IS NOT TO  
BE USED FOR ANY PURPOSE  
WITHOUT OUR APPROVAL.