

PART NUMBER

**KCC187807**

REV.

DATE

COMMENTS

INITIAL

**Electrical Data**

Impedance 50  $\Omega$   
 Frequency Range DC - 18 GHz.  
 Voltage Rating 500 Max  
 Insulation Resistance  $\geq 5,000 M\Omega$   
 Dielectric Withstanding Voltage 750 VRMS  
 VSWR  $\leq 1.25$  Max @ 18 GHz

**Mechanical Data**

Temperature Range: -65 °C - 165 °C

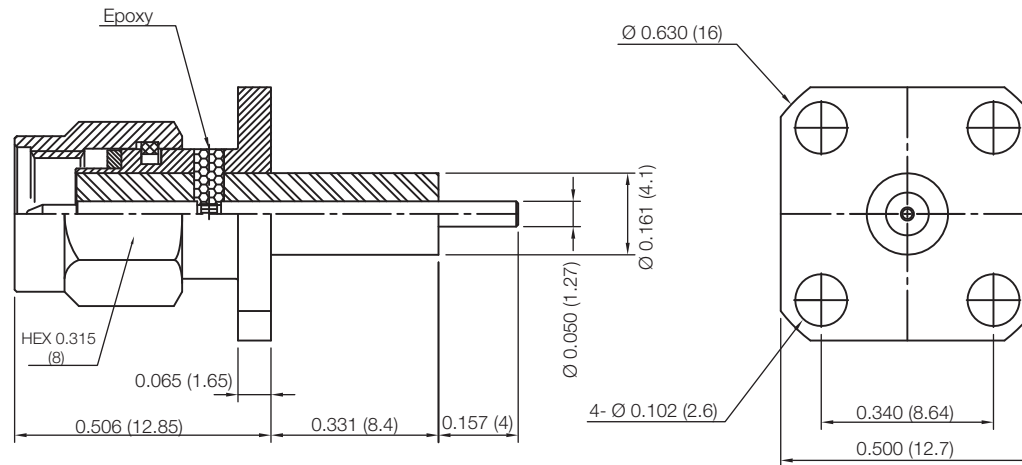
**RoHS Compliant**

Drawing not to scale. Dimensions for reference only

Units: inches (mm)

**Konnect RF**

WWW.KONNECTRF.COM  
 1-800-790-5887

PART NUMBER

**KCC187807**

DESCRIPTION

**SMA Straight Male Plug Receptacle, 4 Hole  
 Flange Mount, Extended Teflon, Blunt Post, Epoxy Captivated**

CAGE CODE

**664U0**

SIGNATURE

X

THIS DRAWING INCLUDING THE  
 DESIGNS IS THE PROPERTY OF  
 KONNECT RF AND IS NOT TO  
 BE USED FOR ANY PURPOSE  
 WITHOUT OUR APPROVAL.

**Component**  
 Body & Nut  
 Center Contact  
 Insulator

**Material**  
 Stainless Steel  
 Brass  
 PTFE

**Plating/Finish**  
 Passivated  
 Gold