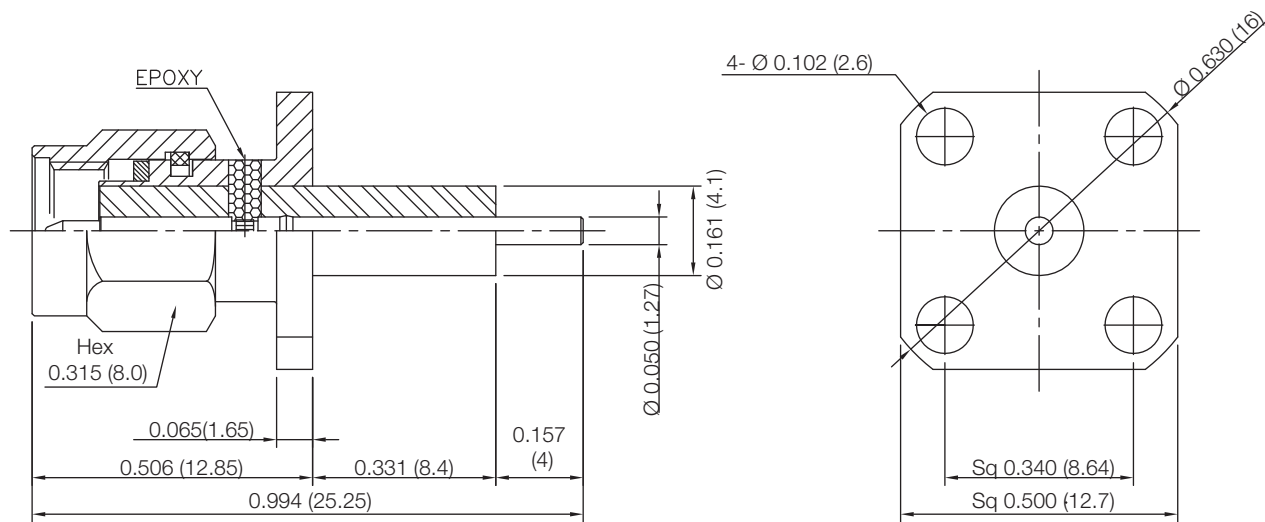

PART NUMBER

KCC187803

REV.

INITIAL

Electrical Data**RoHS Compliant**Impedance 50 Ω 

Drawing not to scale. Dimensions for reference only

Units: inches (mm)

Konnnect RFWWW.KONNECTRF.COM
1-800-790-5887

PART NUMBER

KCC187803

DESCRIPTION

**SMA Straight Male Plug Receptacle
4 Hole Flange Mount, Blunt Post**

CAGE CODE

664U0

SIGNATURE

X

THIS DRAWING INCLUDING THE
DESIGNS IS THE PROPERTY OF
KONNECT RF AND IS NOT TO
BE USED FOR ANY PURPOSE
WITHOUT OUR APPROVAL.

Component

Body, Coupling Nut
Center Contact
Insulator

Material

Stainless Steel
Brass
PTFE

Plating

Gold
Gold