

PART NUMBER

**KCC179962****Electrical Data**

Impedance 50  $\Omega$   
 Frequency Range DC - 4 GHz.  
 Voltage Rating 250 VRMS

**Mechanical Data**

Durability 500 Cycles Min.  
 Temperature Range: -65 °C - 125 °C

**Standards**

Corrosion Resistance MIL-STD-202, Method 101, Condition B  
 Moisture Resistance MIL-STD-202, Method 106  
 Thermal Shock MIL-STD-202, Method 107, Condition B  
 Vibration MIL-STD-202, Method 204, Condition D

**RoHS Compliant**

REV.	DATE	COMMENTS	INITIAL
A	05-23-14	Updated Center Pin Placement	<i>MP</i>
B	06-25-14	Changed Captivation Method & Updated Connector Body & Contact Length	<i>MP</i>
C	07-11-14	Increased depth of dimple to improve Captivation Strength	<i>MP</i>
D	07-31-14	Changed Center Contact Length From 4.5mm to 2.2mm	<i>MP</i>

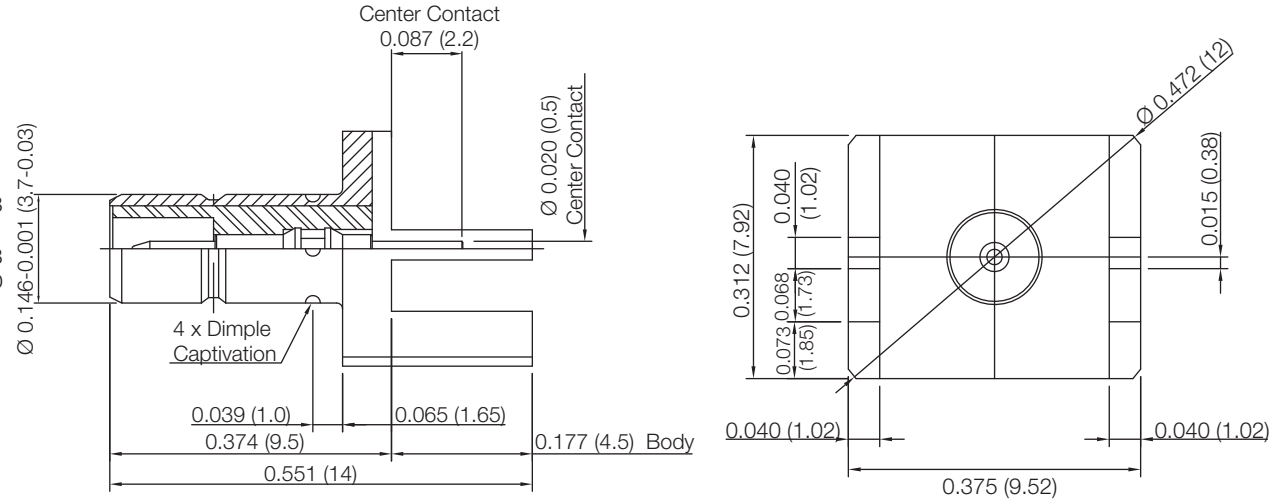

Drawing not to scale. Dimensions for reference only

Units: inches (mm)

**Konnect RF**

WWW.KONNECTRF.COM  
 1-800-790-5887

PART NUMBER

**KCC179962**

DESCRIPTION

**SMB Straight Male Jack Edge Mount PC Board Receptacle for .062 Inch board**

CAGE CODE

**664U0**

SIGNATURE

**X**

THIS DRAWING INCLUDING THE DESIGNS IS THE PROPERTY OF KONNECT RF AND IS NOT TO BE USED FOR ANY PURPOSE WITHOUT OUR APPROVAL.

**Component**

Body  
 Center Contact  
 Insulator

**Material**

Brass  
 Brass  
 PTFE

**Plating**

Gold  
 Gold