

PART NUMBER

KCC179386

REV.

DATE

COMMENTS

INITIAL

Electrical Data

Impedance	Non Constant
Frequency Range	DC - 0.3 GHz.
Working Voltage	500 VRMS Max. @ Sea Level

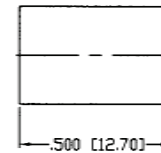
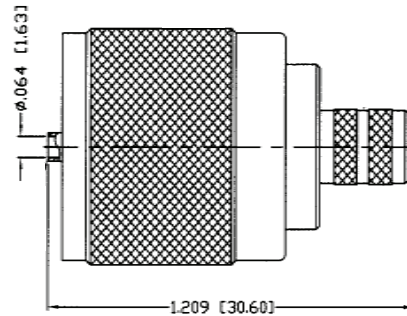
RoHS Compliant

RECOMMENDED CRIMP DIE: .255"

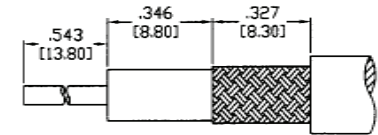

RECOMMENDED STRIPPING DIMENSIONS

VSWR and Frequency Range Specifications
are for reference and are dependant on cable
type and other application specific conditions

Drawing not to scale. Dimensions for reference only

Units: inches (mm)

Konnect RF

WWW.KONNECTRF.COM
1-800-790-5887

PART NUMBER

KCC179386

DESCRIPTION

UHF Straight Male Plug, Crimp

CAGE CODE

664U0

SIGNATURE

X

THIS DRAWING INCLUDING THE
DESIGNS IS THE PROPERTY OF
KONNECT RF AND IS NOT TO
BE USED FOR ANY PURPOSE
WITHOUT OUR APPROVAL.

Cable Types: RG-8X, LMR-240, Belden 9258**Component**

Body & Ferrule
Center Contact
Insulator

Material

Brass
Brass
Phenolic

Plating

Nickel
Silver