

PART NUMBER

KCC178925

REV.

DATE

COMMENTS

INITIAL

Electrical Data

| | |
|---------------------------------|--|
| Impedance | 50 Ω |
| Frequency Range | DC - 18.0 GHz. |
| Voltage Rating | 500 Max |
| Insulation Resistance | 5,000 M Ω |
| Dielectric Withstanding Voltage | 750 VRMS |
| VSWR | 1.20 Max @ 12.4 GHz 1.30 Max @ 18.0 GHz |

Mechanical Data

Temperature Range: -65 °C - 165 °C

* Interface Per MIL-STD-348

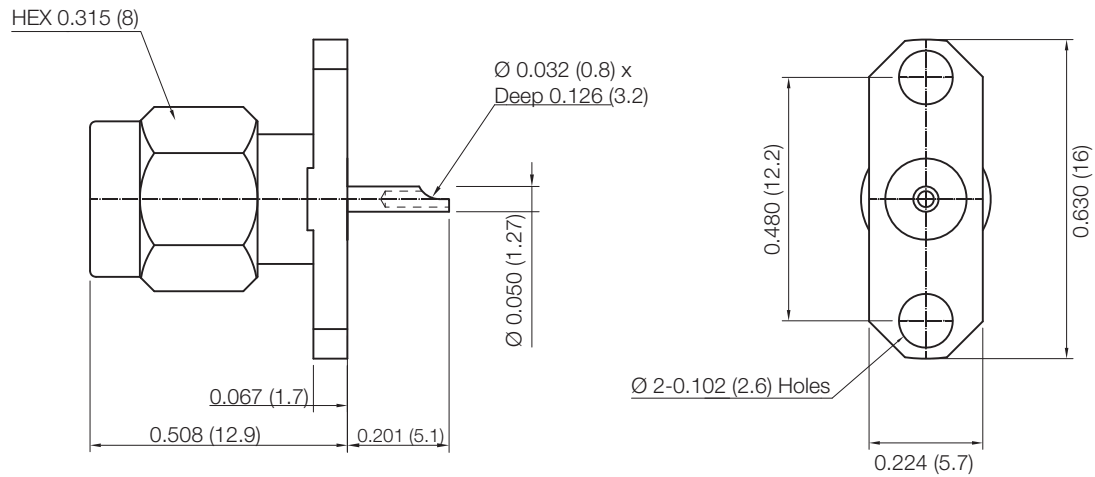
RoHS Compliant

Drawing not to scale. Dimensions for reference only

Units: inches (mm)

Konnnect RFWWW.KONNECTRF.COM
1-800-790-5887

PART NUMBER

KCC178925

DESCRIPTION

**SMA Straight Male Plug Receptacle,
2 Hole Flange Mount, Solder Pot**

CAGE CODE

664U0

SIGNATURE

X

THIS DRAWING INCLUDING THE
DESIGNS IS THE PROPERTY OF
KONNECT RF AND IS NOT TO
BE USED FOR ANY PURPOSE
WITHOUT OUR APPROVAL.**Component**Body, Nut
Center Contact
Insulator**Material**Stainless Steel
Brass
PTFE**Plating/Finish**Passivated
Gold