

PART NUMBER

KCC178650

REV.

INITIAL

Electrical Data

Impedance	50 Ω
Frequency Range	DC - 18 GHz
Insulation Resistance	≥5000 MΩ
Center Conductor	≤3.0 MΩ
Outer Conductor	≤5.0 MΩ
I _{VW}	≥1000 V
Durability	≥500 Cycles

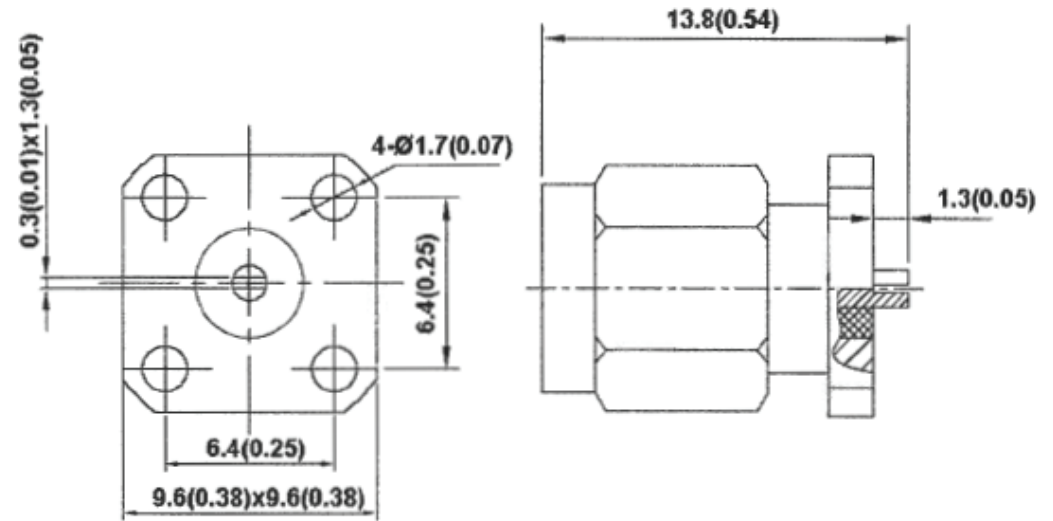
RoHS Compliant

VSWR and Frequency Range Specifications
are for reference and are dependant on cable
type and other application specific conditions

Drawing not to scale. Dimensions for reference only

Units: mm [inches]

WWW.KONNECTRF.COM
1-800-790-5887

PART NUMBER

KCC178650

DESCRIPTION

SMA Straight Male Plug Receptacle, 4 Hole Flange Mount, Slot Terminal (0.01"), Captivated

CAGE CODE

664U0

SIGNATURE

X

THIS DRAWING INCLUDING THE
DESIGNS IS THE PROPERTY OF
KONNECT RF AND IS NOT TO
BE USED FOR ANY PURPOSE
WITHOUT OUR APPROVAL.

Component

Body
Center Conductor
Insulator

Material

Stainless Steel
Be.Cu
PTFE

Plating

Passivated
Gold