

PART NUMBER

KCC178614

REV.

INITIAL

Electrical Data

Impedance	50 Ω
Frequency Range	DC - 6 GHz.
Insertion Loss	0.15 dB max.
Working Voltage	480 VRMS
Test Voltage	750 VRMS
Insulation Resistance	5,000 M Ω
VSWR	\leq 1.35

Mechanical Data

Durability	500 Cycles Min.
Temperature Range:	-55 $^{\circ}$ C - 155 $^{\circ}$ C

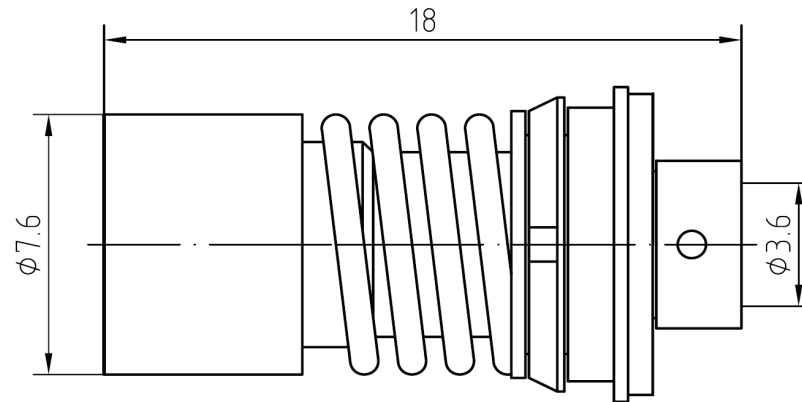
RoHS Compliant

VSWR and Frequency Range Specifications are for reference and are dependant on cable type and other application specific conditions

Drawing not to scale. Dimensions for reference only

Units: mm

WWW.KONNECTRF.COM
1-800-790-5887

PART NUMBER

KCC178614

DESCRIPTION

BMA Straight Female Plug, Solder

CAGE CODE

664U0

SIGNATURE

X

Cable Types: .141 S/R (RG-402)**Component**

Body
Center Contact
Outer Contact
Insulator

Material

Brass
Ber. Bronze
Ber. Bronze
PTFE

Plating

Gold
Gold
Gold

THIS DRAWING INCLUDING THE DESIGNS IS THE PROPERTY OF KONNECT RF AND IS NOT TO BE USED FOR ANY PURPOSE WITHOUT OUR APPROVAL.