

PART NUMBER

KCC178254

REV.

DATE

COMMENTS

INITIAL

Electrical Data

Impedance	50 Ω
Frequency Range	DC - 4 GHz.
Test Voltage	750 VRMS
Working Voltage	500 VRMS
Insertion Loss	0.10 dB max.
Insulation Resistance	$\geq 1,000 M\Omega$
VSWR	≤ 1.3

RoHS Compliant**Mechanical Data**

Durability	500 Cycles Min.
Temperature Range:	-55°C - 155 °C

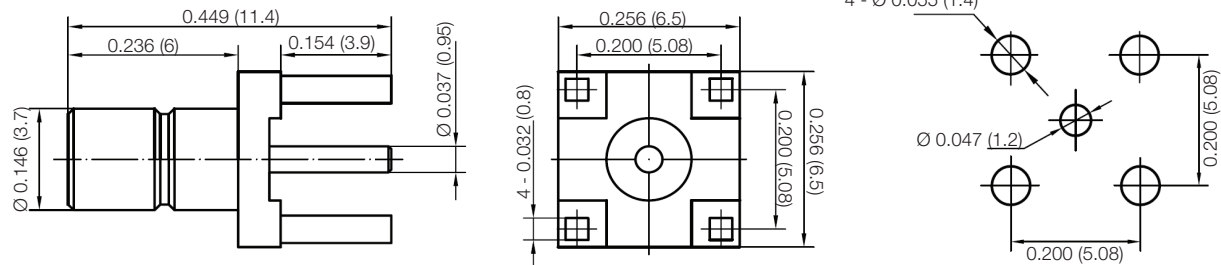

Drawing not to scale. Dimensions for reference only

Units: inches (mm)

Konnect RF

WWW.KONNECTRF.COM
1-800-790-5887

PART NUMBER

KCC178254

DESCRIPTION

SMB Male Jack 4 Leg Standoff PC Board Receptacle

CAGE CODE

664U0

SIGNATURE

X

THIS DRAWING INCLUDING THE
DESIGNS IS THE PROPERTY OF
KONNECT RF AND IS NOT TO
BE USED FOR ANY PURPOSE
WITHOUT OUR APPROVAL.

Component
Body
Center Contact
Insulator

Material
Brass
Brass
PTFE

Plating
Gold
Gold
Gold