

PART NUMBER

**KCC178228**

REV.

DATE

COMMENTS

INITIAL

**Electrical Data**

Impedance 50  $\Omega$   
 Frequency Range DC - 11 GHz.  
 Working Voltage 1,000 VRMS  
 VSWR 1.25 Max @ 2.5 GHz

**Mechanical Data**

Temperature Range: -55 °C - 155 °C

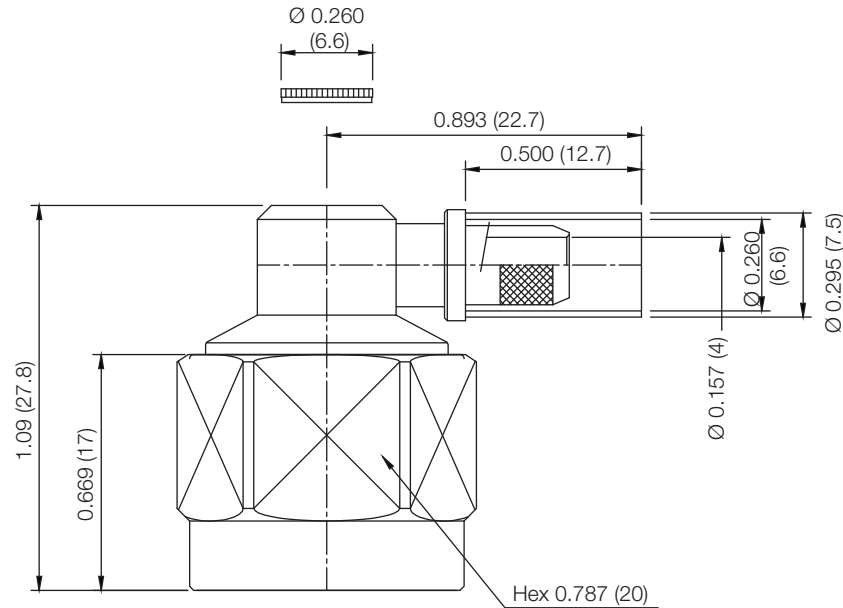
**RoHS Compliant**

**VSWR and Frequency Range Specifications**  
 are for reference and are dependant on cable  
 type and other application specific conditions

Drawing not to scale. Dimensions for reference only

Units: inches (mm)

WWW.KONNECTRF.COM  
 1-800-790-5887

PART NUMBER

**KCC178228**

DESCRIPTION

**N Right Angle Male Plug, Crimp, Hex Nut**

CAGE CODE

**664U0**

SIGNATURE

**X**

THIS DRAWING INCLUDING THE  
 DESIGNS IS THE PROPERTY OF  
 KONNECT RF AND IS NOT TO  
 BE USED FOR ANY PURPOSE  
 WITHOUT OUR APPROVAL.

**Cable Types:** LMR-240**Component**

Body & Coupling Nut  
 Center Contact  
 Ferrule  
 Seal  
 Insulator

**Material**

Brass  
 Brass  
 Brass  
 Silicone Rubber  
 PTFE

**Plating**

White Bronze  
 Gold  
 Nickel