

PART NUMBER

**KCC178116**

REV.

INITIAL

**Electrical Data**

Impedance 50  $\Omega$   
 Frequency Range DC - 6 GHz.  
 Voltage Rating 375 VRMS  
 VSWR  $\leq 1.20$

**RoHS Compliant****Mechanical Data**

Temperature Range: -55 °C - 155 °C

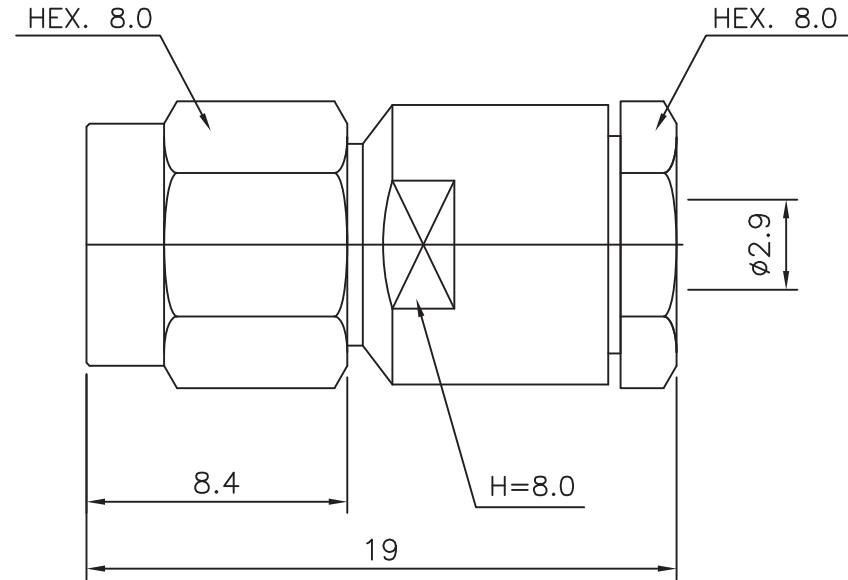

VSWR and Frequency Range Specifications are for reference and are dependant on cable type and other application specific conditions

Drawing not to scale. Dimensions for reference only

Units: mm

WWW.KONNECTRF.COM  
 1-800-790-5887

PART NUMBER

**KCC178116**

DESCRIPTION

**SMA Straight Male Plug, Clamp**

CAGE CODE

**664U0**

SIGNATURE

X

**Cable Types:** RG-174, 188, 316, LMR-100

THIS DRAWING INCLUDING THE DESIGNS IS THE PROPERTY OF KONNECT RF AND IS NOT TO BE USED FOR ANY PURPOSE WITHOUT OUR APPROVAL.

**Component**

Body & Coupling Nut  
 Coupling Cap  
 Center Contact  
 Gasket  
 Insulator

**Material**

Stainless Steel  
 Stainless Steel  
 Brass  
 Silicone Rubber  
 PTFE

**Plating**

Gold  
 Gold  
 Gold