

PART NUMBER

KCC178094

REV.

DATE

COMMENTS

INITIAL

Electrical Data

Impedance	50 Ω
Frequency Range	DC - 18 GHz.
Insertion Loss	0.30 dB
Insulation Resistance	5,000 M Ω
Dielectric Withstanding Voltage	750 VRMS
VSWR	1.5 Max

RoHS Compliant**Mechanical Data**

Durability 500 Cycles Min.

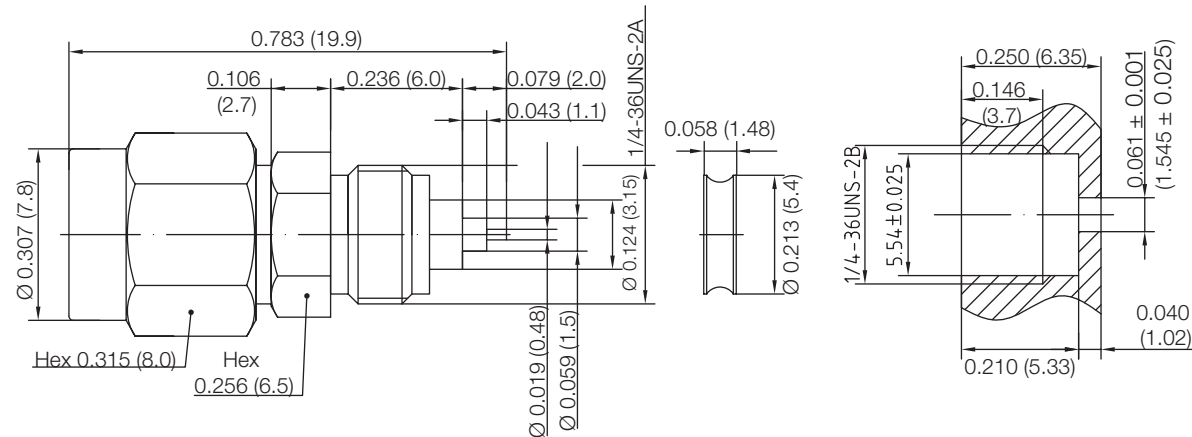

Drawing not to scale. Dimensions for reference only

Units: inches (mm)

Konnect RF

WWW.KONNECTRF.COM
1-800-790-5887

PART NUMBER

KCC178094

DESCRIPTION

SMA Straight Male Plug Receptacle, Bulkhead

CAGE CODE

664U0

SIGNATURE

X

THIS DRAWING INCLUDING THE
DESIGNS IS THE PROPERTY OF
KONNECT RF AND IS NOT TO
BE USED FOR ANY PURPOSE
WITHOUT OUR APPROVAL.

Component

Body & Nut
Center Contact
O-Ring
Insulator

Material

Brass
Brass
Silicone Rubber
PTFE

Plating

Gold
Gold