

PART NUMBER

KCC177962

REV.

DATE

COMMENTS

INITIAL

Electrical Data

Impedance 50 Ω
 Frequency Range DC-6 GHz

RoHS Compliant

Mechanical Data

Temperature Range: -55 °C - 155 °C

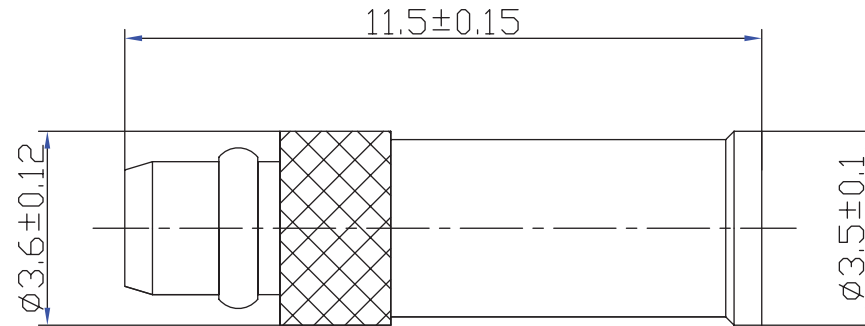

VSWR and Frequency Range Specifications are for reference and are dependant on cable type and other application specific conditions

Drawing not to scale. Dimensions for reference only

Units: mm

The tolerance is ± 0.2 mm unless otherwise specified

WWW.KONNECTRF.COM
 1-800-790-5887

PART NUMBER

KCC177962

DESCRIPTION

MMCX Straight Male Plug, Solder

CAGE CODE

664U0

SIGNATURE

X

THIS DRAWING INCLUDING THE DESIGNS IS THE PROPERTY OF KONNECT RF AND IS NOT TO BE USED FOR ANY PURPOSE WITHOUT OUR APPROVAL.

Cable Type: .085 S/R (RG-405)**Component****Material****Plating**

Body

Brass

Gold

Center Contact

Brass

Gold

Contact Head

BeCu

Gold

Insulator

PTFE