

PART NUMBER

**KCC177935**

REV.

INITIAL

**Electrical Data**

Impedance 50  $\Omega$   
 Frequency Range DC - 6 GHz  
 Voltage Rating 375 V rms  
 VSWR 1.20:1 up to 6 GHz Max.  
 Temperature Range -55°C to +155°C  
 2002/95/EC (RoHS) Compliant

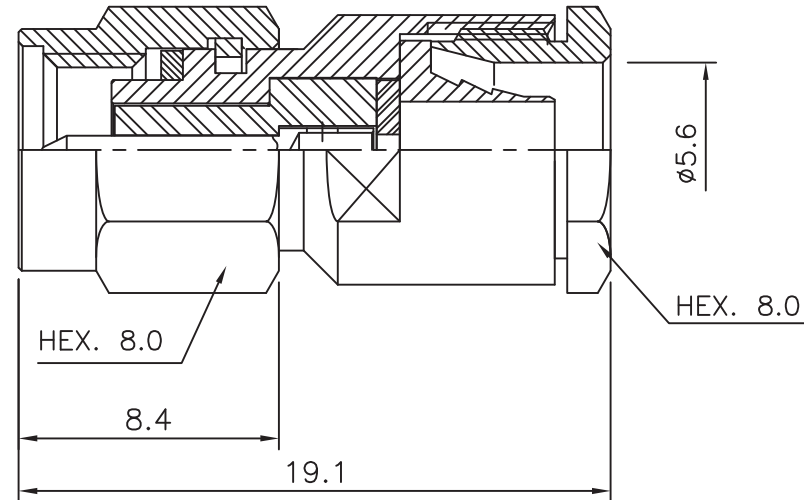
**RoHS Compliant**

VSWR and Frequency Range Specifications are for reference and are dependant on cable type and other application specific conditions

Drawing not to scale. Dimensions for reference only

Units: mm

**Konnnect RF**

WWW.KONNECTRF.COM  
 1-800-790-5887

PART NUMBER

**KCC177935**

DESCRIPTION

**SMA Straight Male Plug  
Clamp**

CAGE CODE

**664U0**

SIGNATURE

X

THIS DRAWING INCLUDING THE DESIGNS IS THE PROPERTY OF KONNECT RF AND IS NOT TO BE USED FOR ANY PURPOSE WITHOUT OUR APPROVAL.

**Cable Types****RG 55, 58, 141, 142, 223, 303, 400****Materials**

Body / Coupling Nut  
 Coupling Cap  
 Center Contact  
 Cable Ferrule  
 Gasket  
 Insulator

Stainless Steel  
 Stainless Steel  
 Brass  
 Brass  
 Silicone Rubber  
 PTFE

Gold Plated  
 Gold Plated  
 Gold Plated  
 Gold Plated