

PART NUMBER

**KCC177903**

REV.

INITIAL

**Electrical Data****RoHS Compliant**

Impedance

50 Ω

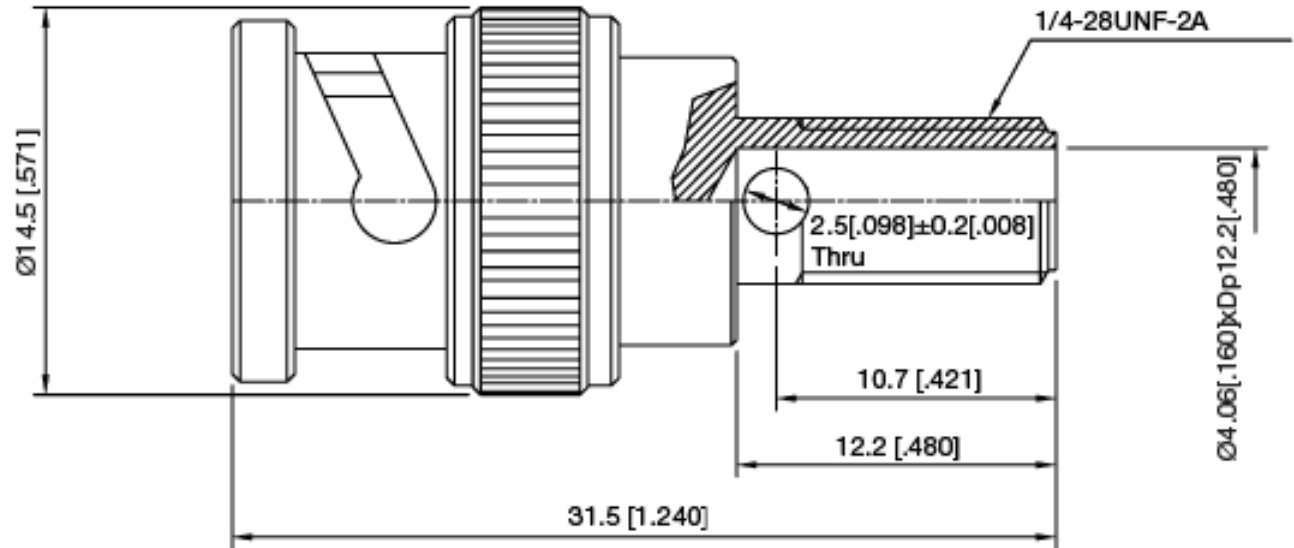

VSWR and Frequency Range Specifications  
are for reference and are dependant on cable  
type and other application specific conditions

Drawing not to scale. Dimensions for reference only

WWW.KONNECTRF.COM  
540 NW University Blvd. Ste. 109  
Port Saint Lucie, Florida, 34986  
1-800-790-5887

PART NUMBER

**KCC177903**

DESCRIPTION

**BNC Straight Male Plug Receptacle  
Binding Post Body**

CAGE CODE

**664U0**

SIGNATURE

X

**Materials**

Body / Coupling Cap  
Center Contact  
Gasket  
Insulator

Brass  
Brass  
Silicone Rubber  
PTFE

Nickel Plated  
Nickel Plated

THIS DRAWING INCLUDING THE  
DESIGNS IS THE PROPERTY OF  
KONNECT RF AND IS NOT TO  
BE USED FOR ANY PURPOSE  
WITHOUT OUR APPROVAL.