

PART NUMBER

**KCC177848**

REV.

DATE

COMMENTS

INITIAL

A

03-04-14

Added Electrical Specs.

**Electrical Data**

Impedance	50 $\Omega$
Frequency Range	DC - 4.0 GHz.
Contact Current	DC 3.5A Max
Voltage Rating	250 VRMS
Contact Resistance	
Center	$\leq 2.0$ m $\Omega$
Outer	$\leq 0.2$ m $\Omega$
Insulation Resistance	$\geq 5,000$ M $\Omega$ Min
VSWR	$\leq 1.2$ at 3 GHz

**Mechanical Data**

Durability	500 Cycles Min.
Temperature Range:	-65 $^{\circ}$ C - 125 $^{\circ}$ C
Coupling Nut Torque	20Ncm-170Ncm
Contact Captivation	$\geq 27$ N

**Environmental**

Corrosion Resistance	MIL-STD-202, Method 101, Condition B
Moisture Resistance	MIL-STD-202, Method 106
Thermal Shock	MIL-STD-202, Method 204, Condition B
Vibration	MIL-STD-202, Method 204, Condition B
Shock	MIL-STD-202, Method 213, Condition G

**VSWR and Frequency Range Specifications are for reference and are dependant on cable type and other application specific conditions**

**Drawing not to scale. Dimensions for reference only**

**Units: inches (mm)**

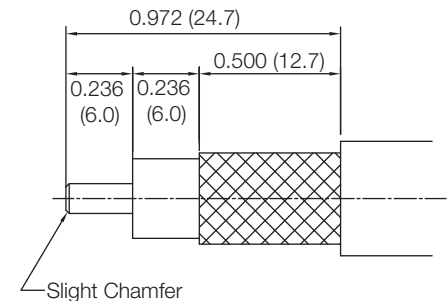
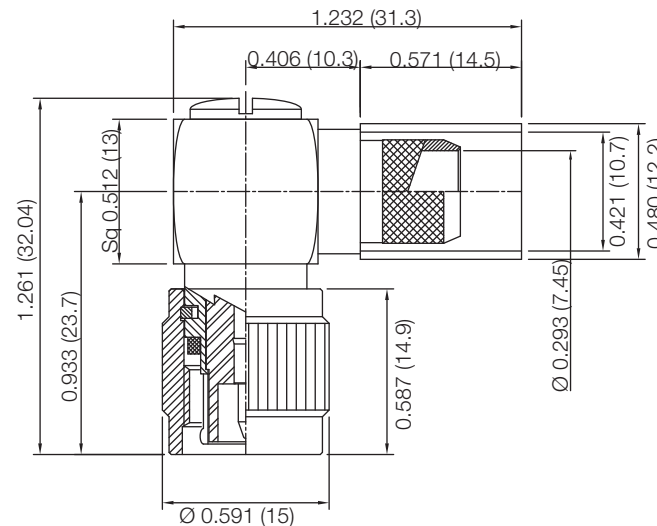
**RoHS Compliant**

Recommended Stripping DIM's  
Recommended Crimp Dies : Hex 10.7

**Konnect RF**

WWW.KONNECTRF.COM  
1-800-790-5887

PART NUMBER

**KCC177848**

DESCRIPTION

**TNC Right Angle Male Plug, Crimp**

CAGE CODE

**664U0**

SIGNATURE

**X****Cable Types:** RG-8 & LMR-400**Component**

Body & Coupling Nut  
Center Contact  
Ferrule  
Gasket  
Insulator

**Material**

Brass  
Brass  
Brass  
Silicone Rubber  
PTFE

**Plating**

Nickel  
Gold  
Nickel

THIS DRAWING INCLUDING THE DESIGNS IS THE PROPERTY OF KONNECT RF AND IS NOT TO BE USED FOR ANY PURPOSE WITHOUT OUR APPROVAL.