

PART NUMBER

KCC177749

REV.

DATE

COMMENTS

INITIAL

Electrical Data

Impedance 50 Ω
 Frequency Range DC - 12.4 GHz.
 Working Voltage 250 VRMS max
 Insulation Resistance 1,000 M Ω
 Dielectric Withstanding Voltage 750 V min
 VSWR 1.20 + 0.03xF (GHz)

Mechanical Data

Temperature Range: -55 °C - 145 °C

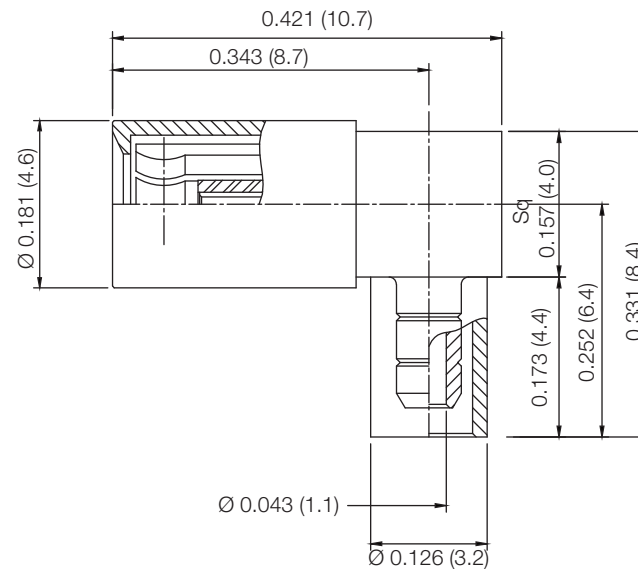
RoHS Compliant

VSWR and Frequency Range Specifications are for reference and are dependant on cable type and other application specific conditions

Drawing not to scale. Dimensions for reference only

Units: inches (mm)

WWW.KONNECTRF.COM
1-800-790-5887

PART NUMBER

KCC177749

DESCRIPTION

SSMB Right Angle Female Plug, Crimp

CAGE CODE

664U0

SIGNATURE

X

Cable Type: RG-178

Component
Body & Ferrule
Center Contact
Insulator

Material
Brass
BeCu
PTFE

Plating
Gold
Gold

THIS DRAWING INCLUDING THE DESIGNS IS THE PROPERTY OF KONNECT RF AND IS NOT TO BE USED FOR ANY PURPOSE WITHOUT OUR APPROVAL.