

PART NUMBER

KCC177693

REV.

INITIAL

Electrical Data

Impedance 50 Ω
 Frequency Range DC-18 GHz
 VSWR 1.21:1 Max.
 DWW 750 VRMS
 Insulation Resistance 5,000 MΩ

Mechanical Data

Temperature Range -55°C ~ 125°C

RoHS Compliant

1/4-36UNS-2A

Accept Pin Dia 0.018 (0.45)
 x0.091 (2.30) Long Max.

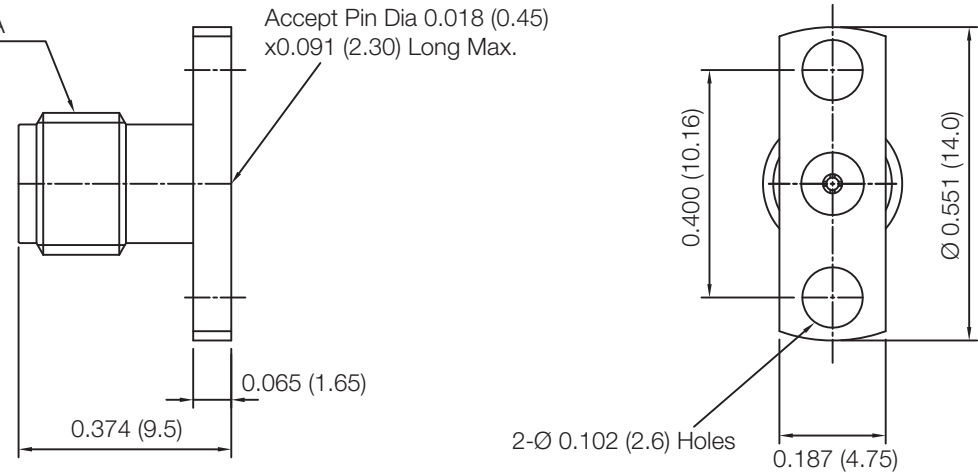

Drawing not to scale. Dimensions for reference only

Units: inches (mm)

Konnnect RF

WWW.KONNECTRF.COM
 1-800-790-5887

PART NUMBER

KCC177693

DESCRIPTION

**SMA Straight Female Jack Field Replaceable Receptacle
2 Hole Flange Mount**

CAGE CODE

664U0

SIGNATURE

X

THIS DRAWING INCLUDING THE
 DESIGNS IS THE PROPERTY OF
 KONNECT RF AND IS NOT TO
 BE USED FOR ANY PURPOSE
 WITHOUT OUR APPROVAL.

Component

Body
 Center Contact
 Insulator

Material

Stainless Steel
 Be.Cu
 PTFE

Plating

Passivated
 Gold