

PART NUMBER

KCC177692

REV.

INITIAL

Electrical Data

Impedance
Temperature Range
Vibration
Condition

50 Ω
-55 ~ +155°C
Method 204
D(20G)

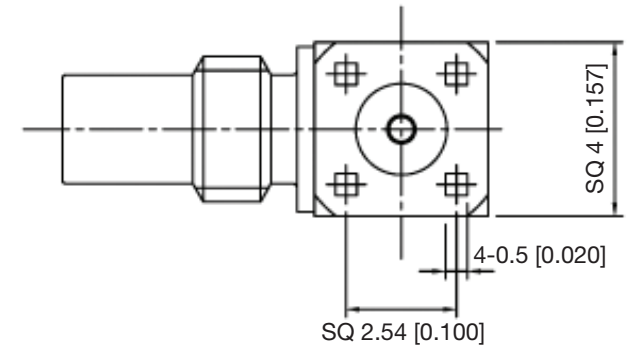
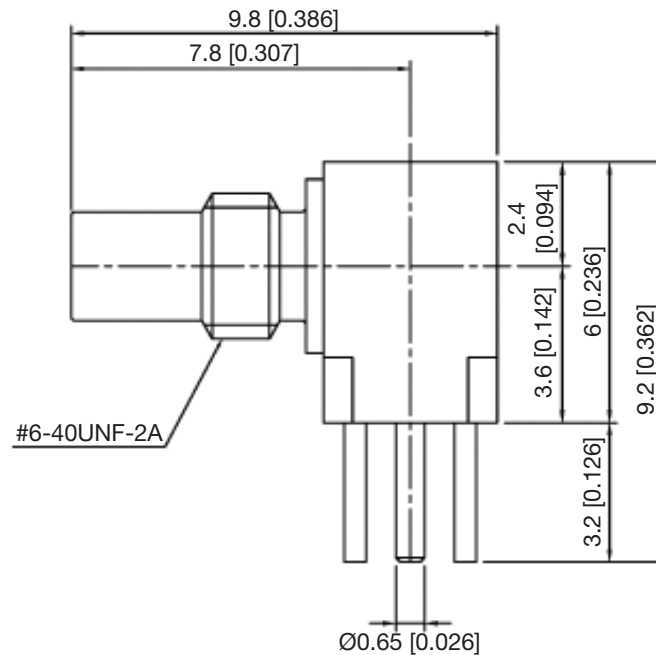
RoHS Compliant

VSWR and Frequency Range Specifications
are for reference and are dependant on cable
type and other application specific conditions

Drawing not to scale. Dimensions for reference only

WWW.KONNECTRF.COM
540 NW University Blvd. Ste. 109
Port Saint Lucie, Florida, 34986
1-800-790-5887

PART NUMBER

KCC177692

DESCRIPTION

**SSMC Right Angle Male Jack 4 Leg PC
Board Receptacle**

CAGE CODE

664U0

SIGNATURE

X

Materials

Body
Center Contact
Insulator

Brass
Brass
PTFE

Gold Plated
Gold Plated

THIS DRAWING INCLUDING THE
DESIGNS IS THE PROPERTY OF
KONNECT RF AND IS NOT TO
BE USED FOR ANY PURPOSE
WITHOUT OUR APPROVAL.