

PART NUMBER

**KCC177678**

REV.

DATE

COMMENTS

INITIAL

**Electrical Data**

Impedance 50  $\Omega$   
 Frequency Range DC -12.4X GHz.  
 VSWR  $\leq 1.2$ : @ 6 GHz

RoHS Compliant

**Mechanical Data**

Durability 500 Matings Min.  
 Temperature Range: -45 °C - 125 °C

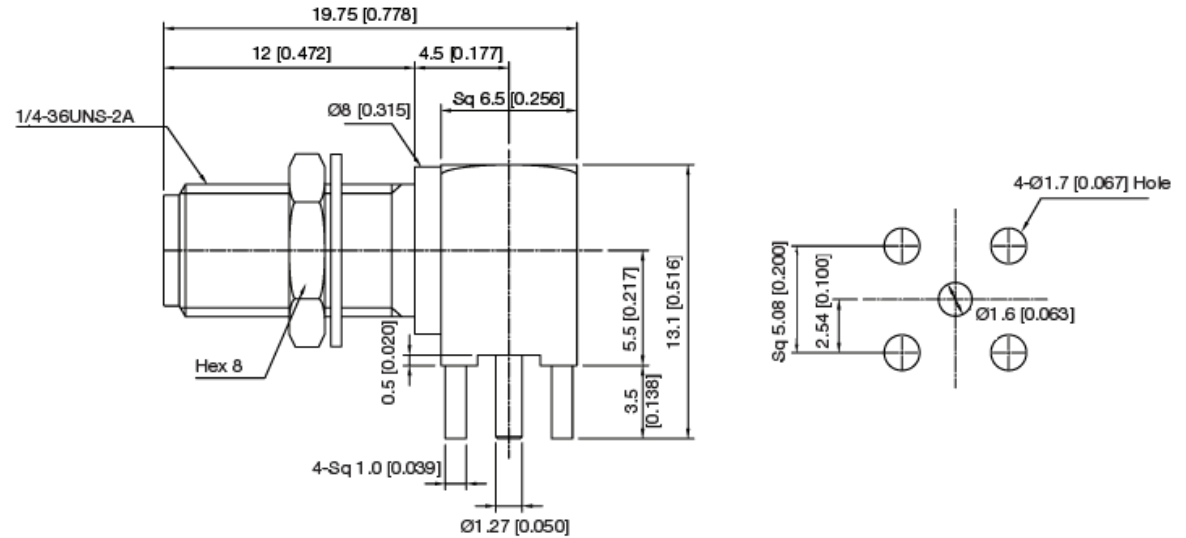

Drawing not to scale. Dimensions for reference only

Units: mm (Inches)

**Konnect RF**

WWW.KONNECTRF.COM  
 1-800-790-5887

PART NUMBER

**KCC177678**

DESCRIPTION

**SMA Right Angle Female Jack 4 Leg PC Board Receptacle, Bulkhead Rear Mount**

CAGE CODE

**664U0**

SIGNATURE

X

THIS DRAWING INCLUDING THE  
 DESIGNS IS THE PROPERTY OF  
 KONNECT RF AND IS NOT TO  
 BE USED FOR ANY PURPOSE  
 WITHOUT OUR APPROVAL.

**Component**

Body, Nut, & Washer  
 Center Contact

Insulator

**Material**

Brass  
 BeCu  
 Brass  
 PTFE

**Plating**

Gold  
 Gold