

PART NUMBER

**KCC177400**

REV.

INITIAL

**Electrical Data**

Impedance

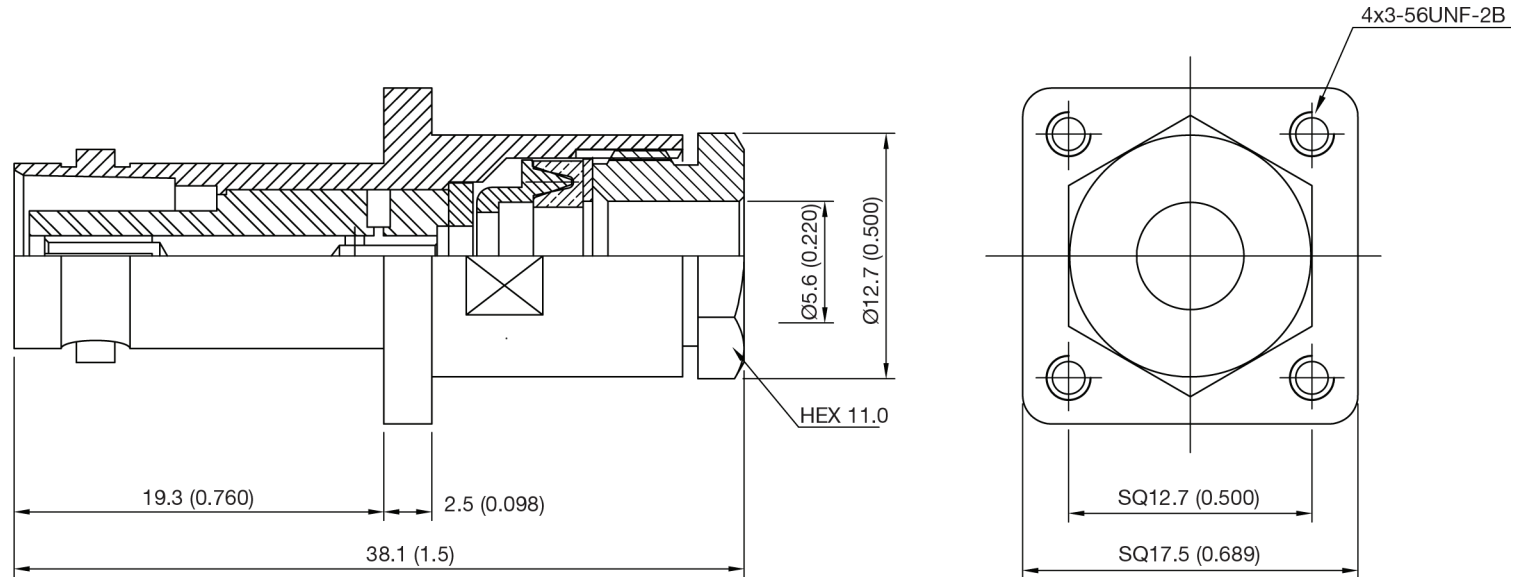
50  $\Omega$ **RoHS Compliant**

VSWR and Frequency Range Specifications  
are for reference and are dependant on cable  
type and other application specific conditions

Drawing not to scale. Dimensions for reference only

WWW.KONNECTRF.COM  
540 NW University Blvd. Ste. 109  
Port Saint Lucie, Florida, 34986  
1-800-790-5887

PART NUMBER

**KCC177400**

DESCRIPTION

**MHV Straight Female Jack - 4-Hole Flange Mount  
Clamp**

CAGE CODE

**664U0**

SIGNATURE

X

Cable Types

RG 58, 142 &amp; 400

Materials

Body / Nut / Cap  
Canter Contact  
Gasket  
Insulator

Brass  
Be-Cu  
Silicone Rubber  
PTFE

Nickel Plated  
Gold Plated

THIS DRAWING INCLUDING THE  
DESIGNS IS THE PROPERTY OF  
KONNECT RF AND IS NOT TO  
BE USED FOR ANY PURPOSE  
WITHOUT OUR APPROVAL.