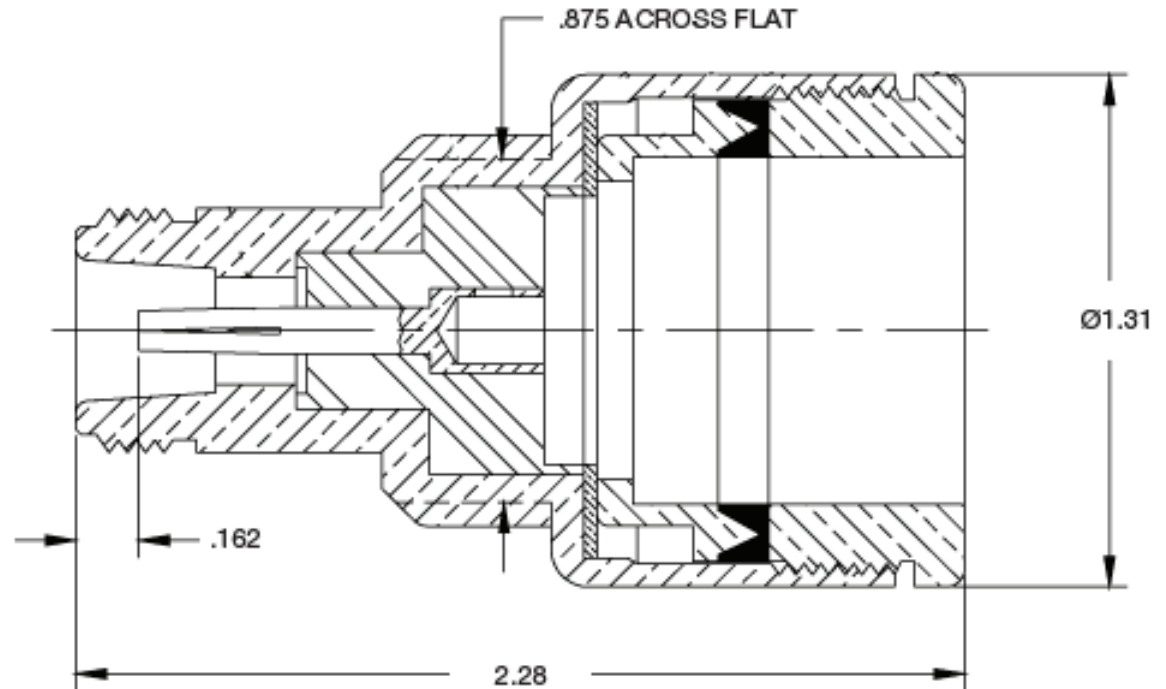

PART NUMBER

KCC177245

REV.

INITIAL

RoHS Compliant

VSWR and Frequency Range Specifications are for reference and are dependant on cable type and other application specific conditions

Drawing not to scale. Dimensions for reference only

Konnect RF

WWW.KONNECTRF.COM
540 NW University Blvd. Ste. 109
Port Saint Lucie, Florida, 34986
1-800-790-5887

PART NUMBER

KCC177245

DESCRIPTION

LC Straight Female Jack - Clamp

CAGE CODE

664U0

SIGNATURE

X

Cable Types

RG 17, 218

Materials

**Body
Contact****Brass
Brass****Nickel Plated
Silver Plated**

THIS DRAWING INCLUDING THE DESIGNS IS THE PROPERTY OF KONNECT RF AND IS NOT TO BE USED FOR ANY PURPOSE WITHOUT OUR APPROVAL.