

PART NUMBER

KCC177186

REV.

DATE

COMMENTS

INITIAL

Electrical Data

Impedance: 50 Ohm
 Frequency Range: DC to 12.4 GHz
 Voltage Rating (AC): 335 Vrms
 Insulation Resistance: 5,000 MOhm
 Dielectric Withstanding Voltage (AC): 1,000 Vrms

Mechanical Data

Temperature Range: -65 °C - 165 °C
 Durability: 500 Cycles Min
 Polarity: Standard
 Interface Specification: MIL-STD-348

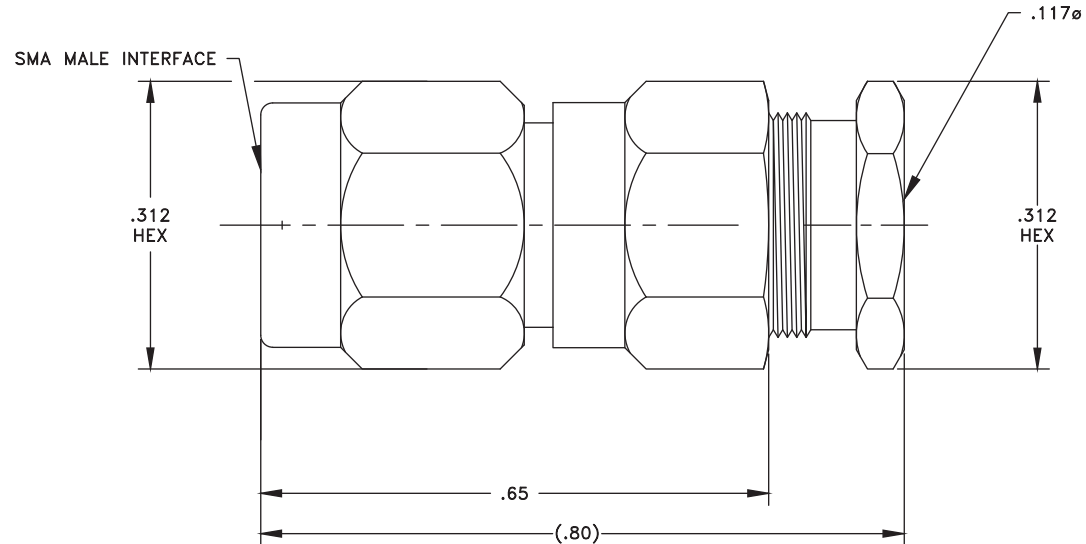
RoHS Compliant

Drawing not to scale. Dimensions for reference only

Units: Inches

Konnect RF

WWW.KONNECTRF.COM
 1-800-790-5887

PART NUMBER

KCC177186

DESCRIPTION

SMA Straight Male Plug, Clamp

CAGE CODE

664U0

SIGNATURE

X

THIS DRAWING INCLUDING THE
 DESIGNS IS THE PROPERTY OF
 KONNECT RF AND IS NOT TO
 BE USED FOR ANY PURPOSE
 WITHOUT OUR APPROVAL.

Component

Body & Coupling Nut
 Center Contact
 Insulators
 Gasket
 Snap Ring
 Cable Clamp
 Cable Nut

Material

Stainless Steel
 Brass
 PTFE
 Silicone
 BeCu
 Nickel Silver Alloy
 Stainless Steel

Plating/Finish

Passivated
 Gold
 Gold
 Passivated