

PART NUMBER

KCC177134

REV.

INITIAL

Electrical Data

Impedance	50 Ω
Frequency Range	DC - 40 GHz
Contact Resistance	$\leq 3.0 \text{ M}\Omega$
Center Conductor	$\leq 5.0 \text{ M}\Omega$
Outer Conductor	
Insulation Resistance	$\geq 5000 \text{ M}\Omega$
Insulator Withstanding	1000 V
VSWR	≤ 1.30
Durability	500 Cycles

RoHS Compliant

VSWR and Frequency Range Specifications are for reference and are dependant on cable type and other application specific conditions

Drawing not to scale. Dimensions for reference only

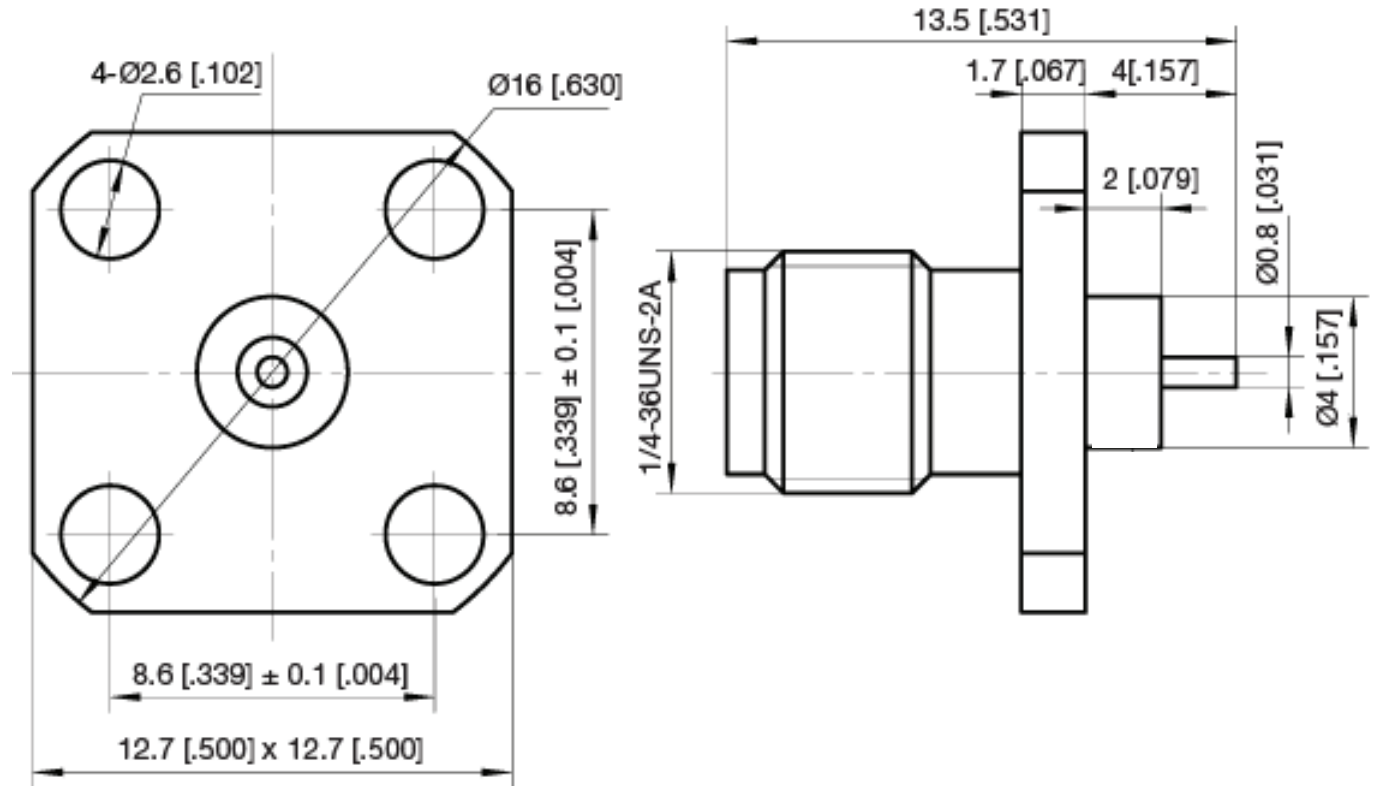

WWW.KONNECTRF.COM
540 NW University Blvd. Ste. 109
Port Saint Lucie, Florida, 34986
1-800-790-5887

PART NUMBER

KCC177134

DESCRIPTION

**2.92mm Straight Female Jack Receptacle
4 Hole Flange Mount - Blunt Post**

CAGE CODE

664U0

SIGNATURE

X

Materials

Body
Center Contact
Insulator

Stainless Steel
Be.Cu
PEI MPPO

Passivated
Gold Plated

THIS DRAWING INCLUDING THE DESIGNS IS THE PROPERTY OF KONNECT RF AND IS NOT TO BE USED FOR ANY PURPOSE WITHOUT OUR APPROVAL.