

PART NUMBER

KCC177121

REV.

DATE

COMMENTS

INITIAL

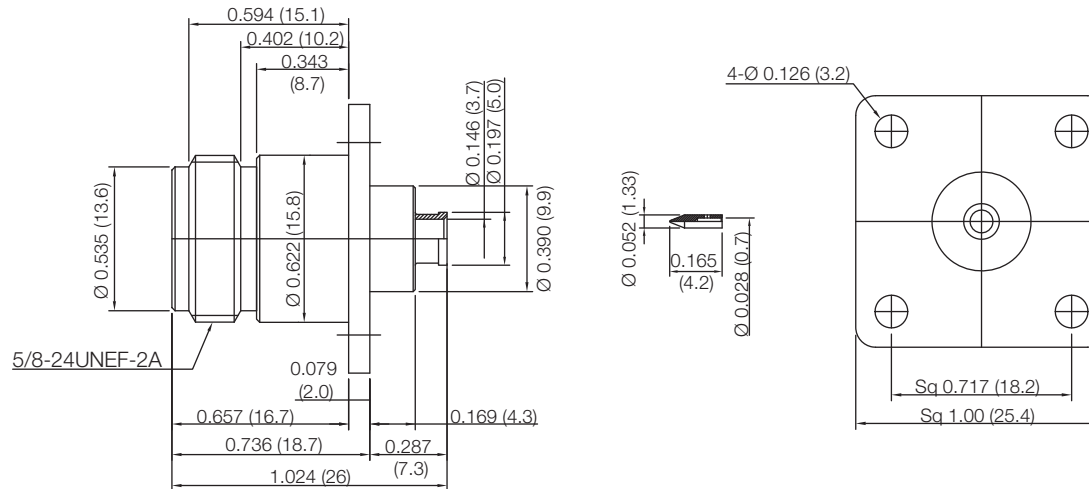
Electrical DataImpedance 50 Ω **RoHS Compliant**

Drawing not to scale. Dimensions for reference only

Units: inches (mm)

Konnect RF

WWW.KONNECTRF.COM
1-800-790-5887

PART NUMBER

KCC177121

DESCRIPTION

N Straight Female Jack, 4 Hole Flange Mount (1.0"), Solder

CAGE CODE

664U0

SIGNATURE

X

THIS DRAWING INCLUDING THE DESIGNS IS THE PROPERTY OF KONNECT RF AND IS NOT TO BE USED FOR ANY PURPOSE WITHOUT OUR APPROVAL.

Cable Types: .141 S/R (RG-402)**Component**

Body
Cable Insert Pin
Center Contact
Insulator

Material

Brass
Brass
BeCu
PTFE

Plating

Nickel
Gold
Gold