

PART NUMBER

KAT178603

REV.

DATE

COMMENTS

INITIAL

Electrical Data

Impedance	50Ω
Average Power	2W
Peak Power	100W (5μs pulse width with 2% duty cycle)
Attenuation Step Size	0-100dB in 1 dB Step
Attenuation Accuracy	≤10dB ±0.5dB <60dB±0.8dB or 3% <70dB±1.5dB or 3% ≥70dB±3.5%
VSWR	1.30 Max
Insertion Loss	≤1.0dB

RoHS Compliant**Mechanical Data**

Temperature Range: -20 °C - 85 °C

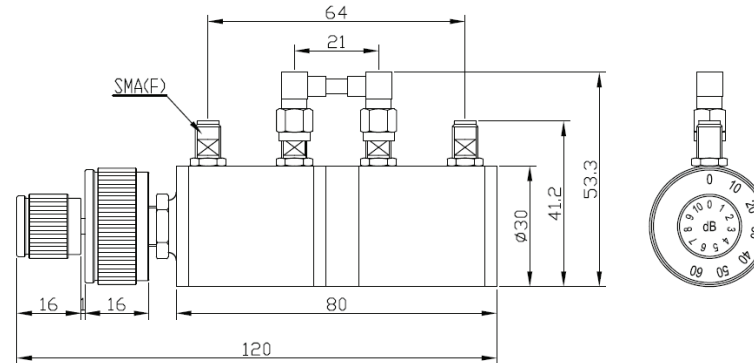

Drawing not to scale. Dimensions for reference only

Units: mm Tolerance ±5%

Konnect RFWWW.KONNECTRF.COM
1-800-790-5887

PART NUMBER

KAT178603

DESCRIPTION

Variable Attenuator, SMA Female

CAGE CODE

664U0

SIGNATURE

X

THIS DRAWING INCLUDING THE
DESIGNS IS THE PROPERTY OF
KONNECT RF AND IS NOT TO
BE USED FOR ANY PURPOSE
WITHOUT OUR APPROVAL.**Component**Body
Female Pin
Housing**Material**Brass
BeCu
Aluminum**Plating**Nickel
Gold
Brass Nickel