

PART NUMBER

**KAT177982-XX**

REV.

DATE

COMMENTS

INITIAL

**Electrical Data**

Impedance	50 $\Omega$
Power Rating	200 Watts @25°C derated linearly to 0 watts @ 125°C
Peak Power	10kW (5 $\mu$ s pulse width, 1% duty cycle)
Frequency Range	DC-6 GHz
Attenuation Range	6-10dB $\pm$ 0.8dB 11-20dB $\pm$ 0.8dB 21-30dB $\pm$ 0.9dB 31-40dB $\pm$ 0.9dB 50-60dB $\pm$ 0.9dB
V.S.W.R	1.20 typical 1.25 maximum ,Can be tailored

**Mechanical Data**

Temperature Range:	-55 $^{\circ}$ C - 125 $^{\circ}$ C
Temperature Coefficient	<0.0004 dB/dB/ $^{\circ}$ C

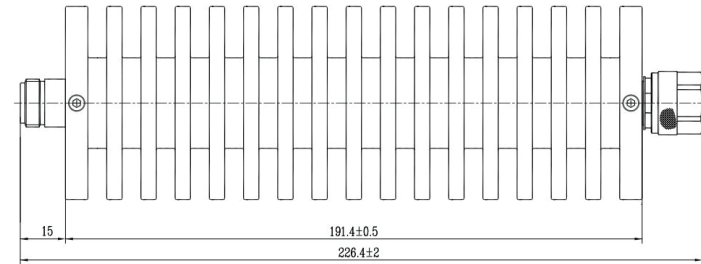
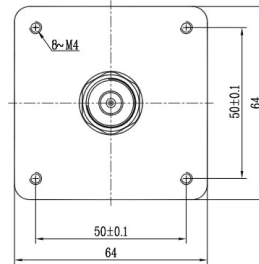
**RoHS Compliant**

Drawing not to scale. Dimensions for reference only

Units: mm

**Konnect RF**

WWW.KONNECTRF.COM  
1-800-790-5887

PART NUMBER

**KAT177982-XX**

DESCRIPTION

**Fixed Attenuator, N Male/Female**

CAGE CODE

**664U0**

SIGNATURE

**X**

THIS DRAWING INCLUDING THE  
DESIGNS IS THE PROPERTY OF  
KONNECT RF AND IS NOT TO  
BE USED FOR ANY PURPOSE  
WITHOUT OUR APPROVAL.

**Component**

Body  
Male Contact  
Female Contact  
Heat Sink

**Material**

Brass  
Brass  
BeCu  
Black Anodized Aluminum

**Plating**

White Bronze  
Gold  
Gold