

PART NUMBER

KAT177585-XX

REV.

DATE

COMMENTS

INITIAL

Electrical Data

Impedance	50 Ω
Frequency Range	DC - 18 GHz.
Attenuation Range & Accuracy	6-9 dB @ +/- 0.75 dB 10 dB @ +/- 0.50 dB 11-20 dB @ +/- 0.75 dB 21-40 dB @ +/- 1.0 dB
Temperature Coefficient	<0.0004 dB/dB/C
Average Power	50
Average Power Description	Maximum rated average power to 25°C ambient temperature, de-rated linearly to 5 W at 125°C.
Peak Power	1kW peak (5 μ sec pulse width, 2.5% duty cycle)
Power Coefficient	<0.0003 dB/dB/W
Directionality	Bidirectional
VSWR	
@ 6 dB Max	1.25 @ DC-8 GHz 1.35 @ 8-12.4 GHz 1.45 @ 12.4-18 GHz
@ 10-40 dB Max	1.20 @ DC-8 GHz 1.25 @ 8-12.4 GHz 1.35 @ 12.4-18 GHz

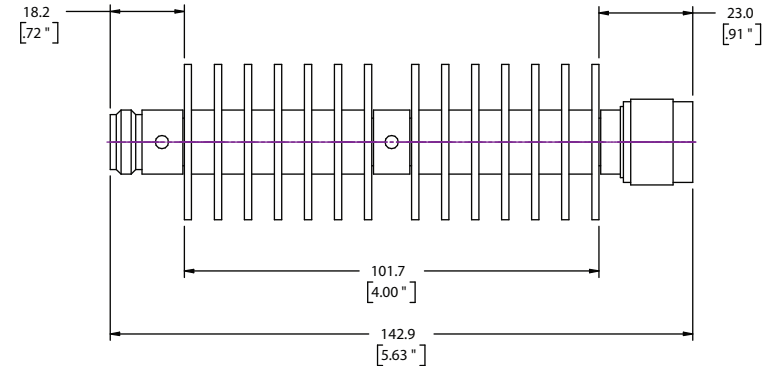
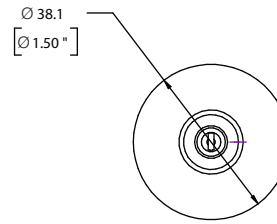

RoHS Compliant

Mechanical Data

Temperature Range: -55 °C - 125 °C

Drawing not to scale. Dimensions for reference only**Units: mm (inches)**

**Drawing shows N Male/Female. KAT177585-XX is provided with TNC Male/Female

Konnect RFWWW.KONNECTRF.COM
1-800-790-5887

PART NUMBER

KAT177585-XX

DESCRIPTION

Fixed Attenuator, TNC Male/Female

CAGE CODE

664U0

SIGNATURE

X

THIS DRAWING INCLUDING THE DESIGNS IS THE PROPERTY OF KONNECT RF AND IS NOT TO BE USED FOR ANY PURPOSE WITHOUT OUR APPROVAL.

ComponentBody
Center Contact**Material**Stainless Steel
Brass**Plating/Finish**Passivated
Gold