

PART NUMBER

KAT177481-XX

REV.

DATE

COMMENTS

INITIAL

Electrical Data

Impedance 50 Ω
 Frequency Range DC - 3 GHz
 Average Power 2W average to 25°C ambient temperature
 derated linearly to 0.5W @ 125°C
 Peak Power 0.5KW (5 μ pulse width with 0.4% duty cycle)
 Attenuation Value & Accuracy 1-9 dB \pm 0.4
 10 dB \pm 0.5
 15 dB \pm 0.5
 20 dB \pm 0.5
 30 dB \pm 0.6
 40 dB \pm 0.6
 VSWR 1.20 max

Mechanical Data

Temperature Range: -55 °C - 125 °C

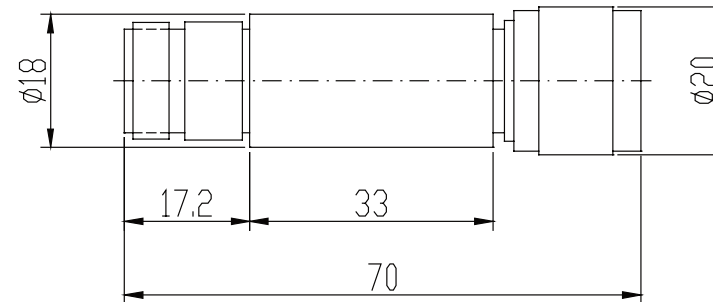
RoHS Compliant

Drawing not to scale. Dimensions for reference only

Units: mm

* Drawing shows N Male to N Female. KAT177481-XX is TNC Male to TNC Female

Konnect RF

WWW.KONNECTRF.COM
 1-800-790-5887

PART NUMBER

KAT177481-XX

DESCRIPTION

Fixed Attenuator, TNC Male/Female, Bidirectional

CAGE CODE

664U0

SIGNATURE

X

THIS DRAWING INCLUDING THE
 DESIGNS IS THE PROPERTY OF
 KONNECT RF AND IS NOT TO
 BE USED FOR ANY PURPOSE
 WITHOUT OUR APPROVAL.

Component

Body
 Male Contact
 Female Contact
 Insulator

Material

Brass
 Brass
 BeCu
 PTFE

Plating

Nickel
 Gold
 Gold