

PART NUMBER

KAT177473

REV.

DATE

COMMENTS

INITIAL

Electrical Data

Impedance 50 Ω
 Frequency Range DC - 2.5 GHz.
 Attenuation Step Size 0-70 dB in 1 dB Steps
 Attenuation Accuracy +/-0.5 dB (≤ 10 dB)
 +/-0.8 dB or 3% (< 60 dB)
 +/-1.5 dB or 3 % (≥ 60 dB)
 Average Power 2W, 10W
 Peak Power 100W (5 μ pulse width with 0.5% duty cycle)
 VSWR 1.30

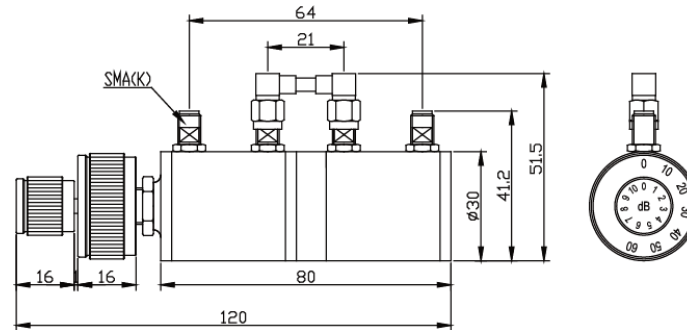
RoHS Compliant**Mechanical Data**Temperature Range: -20 $^{\circ}$ C - 85 $^{\circ}$ C

Drawing not to scale. Dimensions for reference only

Units: (mm)

Konnect RF

WWW.KONNECTRF.COM
 1-800-790-5887

PART NUMBER

KAT177473

DESCRIPTION

Step Attenuator, SMA Female

CAGE CODE

664U0

SIGNATURE

X

THIS DRAWING INCLUDING THE
 DESIGNS IS THE PROPERTY OF
 KONNECT RF AND IS NOT TO
 BE USED FOR ANY PURPOSE
 WITHOUT OUR APPROVAL.