

PART NUMBER

KAT177299

REV.

DATE

COMMENTS

INITIAL

Electrical Data

Impedance	50 Ω
Frequency Range	DC - 4.3 GHz.
Attenuation Step Size	0-70dB in 1 dB Steps
Insertion Loss	≤ 1.5 dB
Attenuation Accuracy	± 0.5 dB (≤ 10 dB) ± 0.8 dB or 3% (< 60 dB) ± 1.5 dB or 3% (≤ 60 dB)
Average Power	2W
Peak Power	100W (5 μ s pulse width with 2% duty Cycle)
Max VSWR	1.40

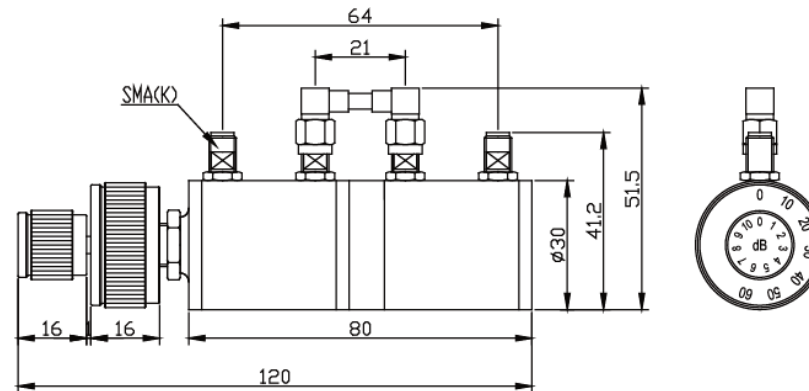
Mechanical DataTemperature Range: -20 $^{\circ}$ C - 85 $^{\circ}$ C**RoHS Compliant**

Drawing not to scale. Dimensions for reference only

Units: mm

Konnect RF

WWW.KONNECTRF.COM
1-800-790-5887

PART NUMBER

KAT177299

DESCRIPTION

Step Attenuator, SMA Female

CAGE CODE

664U0

SIGNATURE

X

THIS DRAWING INCLUDING THE
DESIGNS IS THE PROPERTY OF
KONNECT RF AND IS NOT TO
BE USED FOR ANY PURPOSE
WITHOUT OUR APPROVAL.

Component

Connectors
Female Pin
Housing

Material

Brass
BeCu
Brass

Plating

Nickel
Gold
Aluminum