

PART NUMBER

**KAD187904**

REV.

DATE

COMMENTS

INITIAL

**Electrical Data**

Impedance 50  $\Omega$   
 Frequency Range DC - 11GHz.  
 VSWR max 1.20

**Mechanical Data**

Durability 500 Cycles Min.  
 Temperature Range: -45 °C - 125 °C

**RoHS Compliant**

5/8-24UNEF-2A

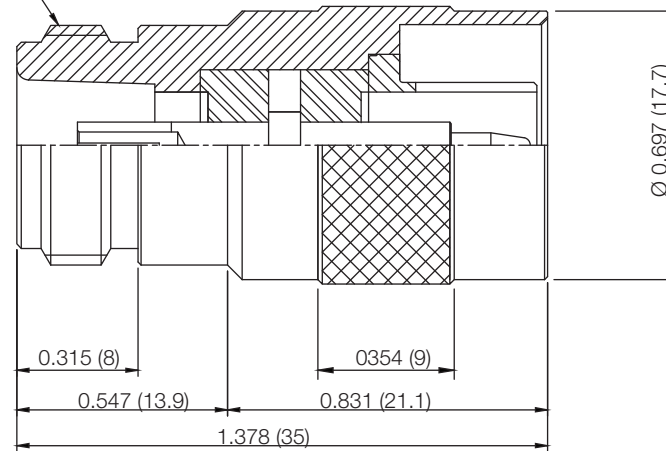

Drawing not to scale. Dimensions for reference only

Units: inches (mm)

**Konnect RF**

WWW.KONNECTRF.COM  
 1-800-790-5887

PART NUMBER

**KAD187904**

DESCRIPTION

**Quick Adapter, In-Series, N Male Plug to Female Jack**

CAGE CODE

**664U0**

SIGNATURE

X

THIS DRAWING INCLUDING THE  
 DESIGNS IS THE PROPERTY OF  
 KONNECT RF AND IS NOT TO  
 BE USED FOR ANY PURPOSE  
 WITHOUT OUR APPROVAL.

**Component**

Body & Cap  
 Center Contact  
 Outer Contact  
 Insulator

**Material**

Brass  
 BeCu  
 BeCu  
 PTFE

**Plating**

Nickel  
 Gold  
 Nickel