

PART NUMBER

KAD187110

REV.

DATE

COMMENTS

INITIAL

RoHS Compliant**Electrical Data**

Impedance	50 Ω
Frequency Range	DC - 6 GHz.
Insertion Loss	0.2dB @ 6GHz
Insulation Resistance	5,000 M Ω min
Dielectric Withstanding Voltage	1,000V Max At Sea level
VSWR	\leq 1.15 @ 6GHz

Mechanical Data

Temperature Range:	-55 $^{\circ}$ C - 165 $^{\circ}$ C
Durability	500 Cycles

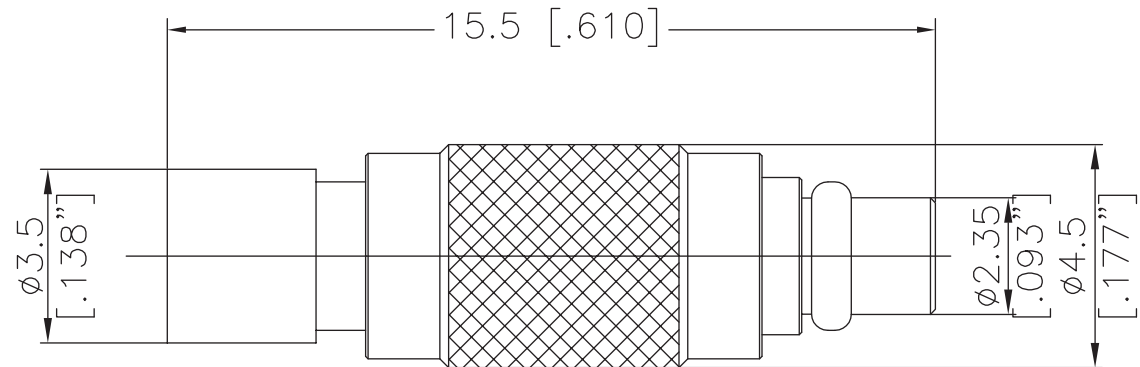

Drawing not to scale. Dimensions for reference only

Units: mm (Inches)

Konnect RF

WWW.KONNECTRF.COM
1-800-790-5887

PART NUMBER

KAD187110

DESCRIPTION

Adapter, In Series, MMCX Straight Male Plug to Female Jack

CAGE CODE

664U0

SIGNATURE

X

THIS DRAWING INCLUDING THE
DESIGNS IS THE PROPERTY OF
KONNECT RF AND IS NOT TO
BE USED FOR ANY PURPOSE
WITHOUT OUR APPROVAL.

Component

Body
Center Contact
Insulator

Material

Brass
BeCu
PTFE

Plating

Gold
Gold