

PART NUMBER

**KAD187077**

REV.

DATE

COMMENTS

INITIAL

## Electrical Data

Impedance	50 $\Omega$
Frequency Range	DC - 18GHz.
Working Voltage	335 VRMS min
Contact Resistance	<3m $\Omega$
Insulation Resistance	5,000M $\Omega$ min
Dielectric Withstanding Voltage	1,000V min
VSWR	1.20 Up to 12.4GHz

## Mechanical Data

Durability	500 Cycles
Temperature Range:	-45 °C - 85 °C

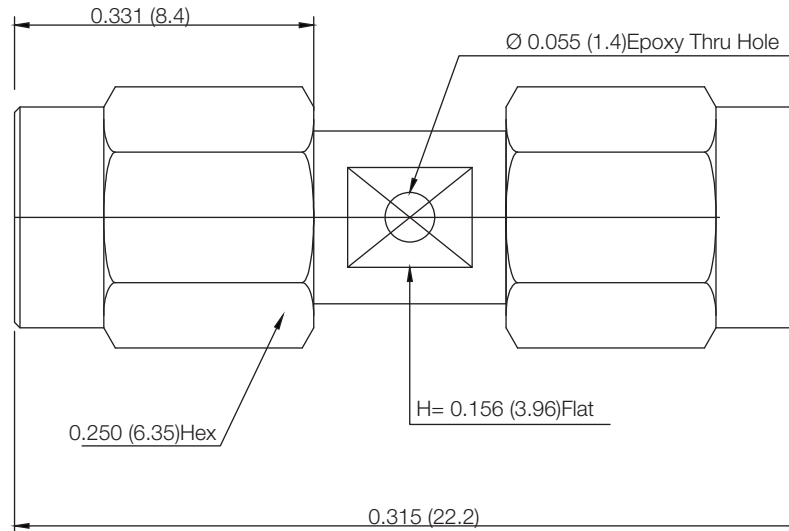
**RoHS Compliant**

Drawing not to scale. Dimensions for reference only

Units: inches (mm)

**Konnect RF**

WWW.KONNECTRF.COM  
1-800-790-5887

PART NUMBER

**KAD187077**

DESCRIPTION

**Adapter, In-Series, SSMA Straight Male Plug to Male Plug**

CAGE CODE

**664U0**

SIGNATURE

X

THIS DRAWING INCLUDING THE  
DESIGNS IS THE PROPERTY OF  
KONNECT RF AND IS NOT TO  
BE USED FOR ANY PURPOSE  
WITHOUT OUR APPROVAL.

Component

Body &amp; Coupling Cap

Center Contact

Insulator

Material

Brass

BeCu

PTFE

Plating

Gold

Gold